

0011-000800 – JOHN DEERE RD & FD SERIES HEADERS with SPLIT REEL INSTRUCTION MANUAL



Approximate time to complete installation is 1-1/2" hours for two people

Recommended tools required for installing the Crop Catcher:

-9/16" socket
-Hammer

-7/16" socket
-Center Punch

-Ratchet
-11/32" Drill Bit

-Extension
-3/8" Drill

-#2 Phillips Screw Driver
-Large Flat Screw Driver

Michel's Industries, Ltd.

P.O. Box 119

St. Gregor, Saskatchewan

S0K 3X0 Canada

Ph#(306)366-2184 or Fax#(306)366-2145

Unpack and check that all the parts are with your Crop Catcher:

Item	QTY	Part No.	Description
1	2	0011-000702	Crop Catcher III Middle Panel
2	2	0011-000801	Top Support
3	2	0011-000802	Bottom Support
4	8	0011-000612	Sweep Support Bracket
5	4	0011-000504	2 Bend Upright Glass Support
6	2	0011-000507L	Mounting Bracket - Left
7	2	0011-000507R	Mounting Bracket - Right
8	1	0011-000803	JD Flex Draper Sweep
9	1	0011-000804	JD Flex Draper Sweep MIR
10	8	0100-001102	3/8"-16 GR2 - Nylock Lock Nut
11	8	0105-009215	3/8"-16 x 1" GR5 - Carriage Bolt - Full Thread
12	36	0100-001401	1/4" Flange Lock Nut
13	28	0105-009002	1/4" x 3/4" Carriage Bolt
14	30	0106-140001	#10-24 x 5/16" - Truss Head Phillips/Slot Machine Screw
15	30	0101-001200	1/4" Lock Washer
16	30	0106-140000	10-24 x 1/4" Binder Post Zinc
17	8	0105-000004	1/4" x 1-1/4" Hex Bolt
18	8	0106-000016	3/8" x 1-1/4" Self Threading Bolt
19	4	0101-001002	3/8" Flat Washer

Mount on front of the plastic panels.

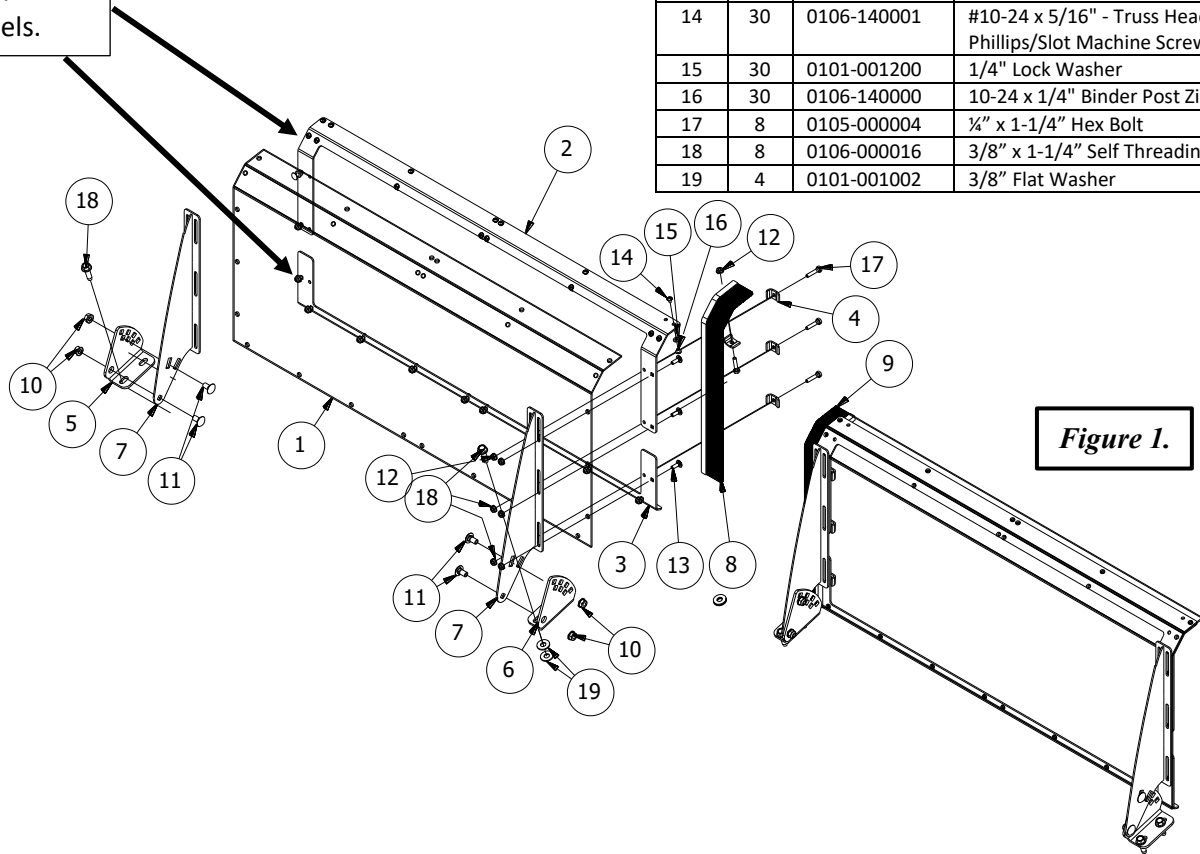
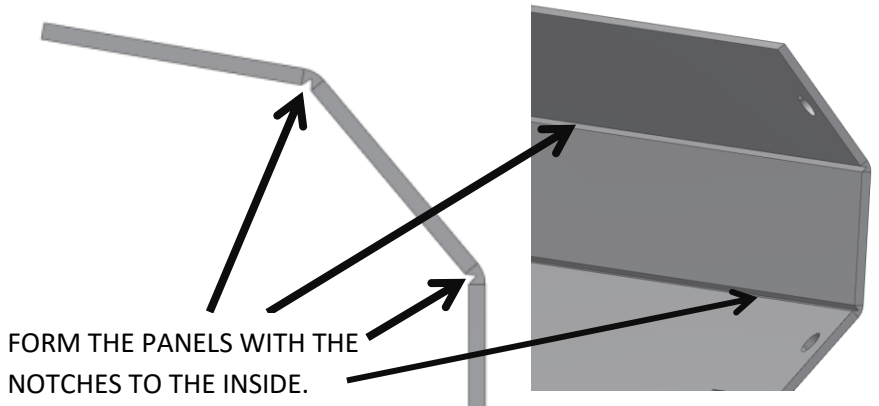

Figure 1.

Glass Forming Procedure:

The panels that are supplied with your Crop Catcher have grooves cut into them where they need to be formed. These grooves need to be on the inside of the glass when they are formed. See Figure 2. The panels can be formed with your hands. It is important to bend the panels all the way until the edges of the grooves touch. Over bending **WILL NOT** cause damage to the panel. Note: Panels may want to straighten out over time and can be re-bent if needed.



FORM THE PANELS WITH THE NOTCHES TO THE INSIDE.

Figure 2.

STEP 1

Bolt the Upright Glass Support Brackets to the Mounting Brackets using two 3/8" carriage bolts. The Upright Glass Support Brackets are mounted on the bent flange side of the Mounting Bracket and the carriage head is also on the bent flange side. Refer to the Figure 3. Clamp the Mounting Bracket to a work bench with the bent flange to the outside. Remove the protective covering on the plastic and wash with soapy water. **Do not use Glass Cleaner to clean the plastic, use the optimal "Dust Away" Plastic Cleaner supplied by Michel's.** Glass cleaner will create unwanted static build up and cause dust to stick to the plastic.

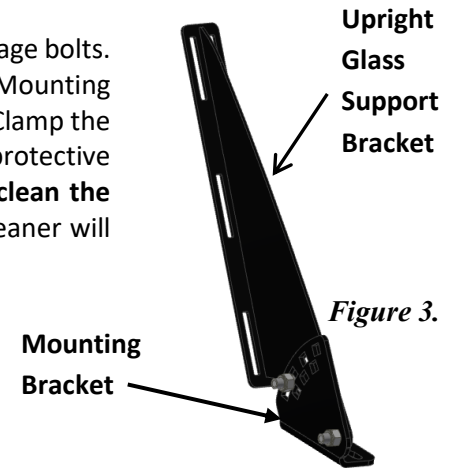

Figure 3.

STEP 2

Install the Bottom Support Brackets across the bottom on front side of the glass, using 1/4" Carriage bolts. The bent flange on the Bottom Support Bracket is mounted forward. See Figure 4. Insert the 1/4" carriage bolts from the front side through the square holes. Bolt this through the bottom slotted holes of the upright Glass Support Bracket. **Note:** Do not tighten hardware until completely assembled.

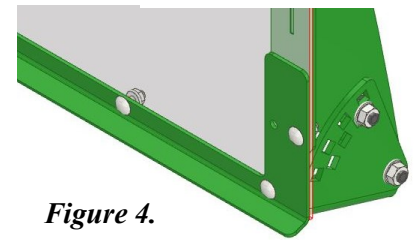

Figure 4.

STEP 3

Install the Top Support Inside Bracket on the front side of the glass and the Upright Glass Support Brackets on the back side of the plastic. The nuts are installed on the back side the panels. The bracket uses Binder Posts and Machine Screws except where it is bolted through the Upright Glass Support Bracket. There it will be secured with 1/4" carriage bolts. Leave the top inside hole open on the inside where the sweep is going to be mounted. See Figure 5. **Note:** Do not tighten hardware until completely assembled.

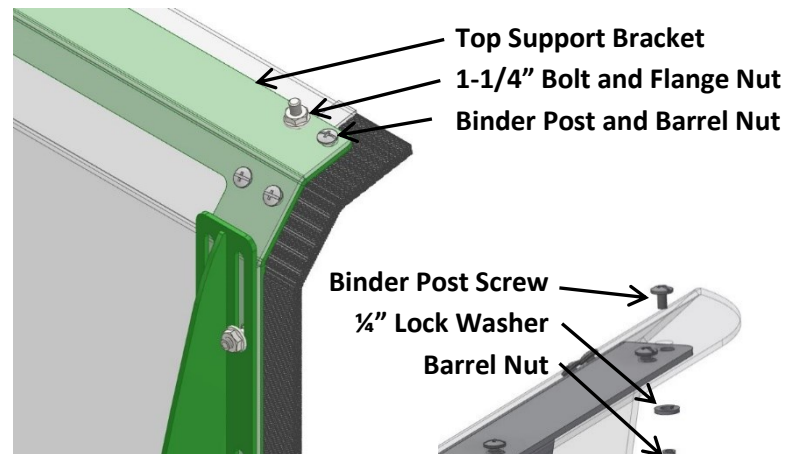

Figure 5.

STEP 4

Install the Binder posts into the top of the Panel and the Top Support Bracket. Use a #2 Phillip Screw Driver and a Large Flat Screw Driver to tighten. Insert the Binder Post from the top side and insert the Barrel Nut and Lock Washer from the bottom. Refer to Figure 6. **Note:** If the plastic panels do not have all of the holes for the Binder Post and Binder Barrel Nuts, drill a 1/4" hole using the Top Support Inside Brackets as a guide. Build both panels the same way.

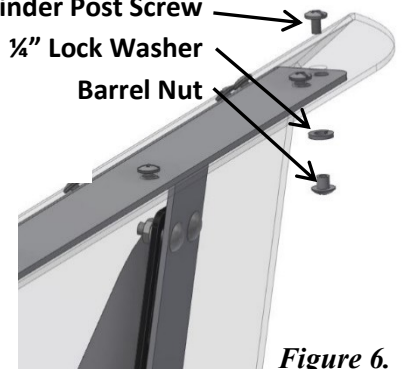

Figure 6.

STEP 5

Clamp the sweep onto the front side of the plastic panel using the Sweep Support Brackets, 1/4" x 1-1/4" bolts and flange nuts. The plastic glass panel will have to be drilled with a 1/4" drill bit to mount the sweep. Install the sweep on the opposite side of the second panel to create a left side and right side panel.

STEP 6

Once the Crop Catcher is all together the bottom carriage bolts can be tightened. Do not over tighten as it may cause damage to the Plastic panel. It is easier to tighten them if the Crop Catcher is laying on it's face. Leave the Upright Support Brackets loose so the complete assembly can slide up and down.

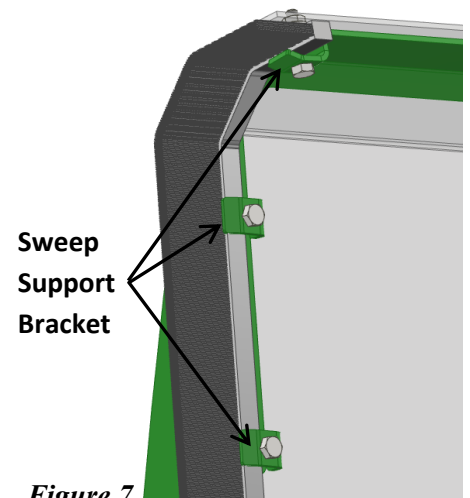
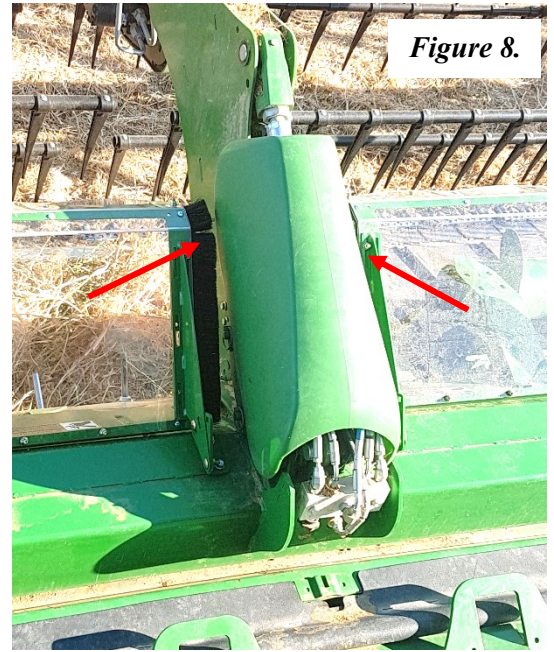

Figure 7.

STEP 7

Mount one panel on each side of the center reel cylinder with the plastic sweep against the cylinder shield. See Figure 8. The mounting brackets mount on the top flat surface. (Blue Arrows) See Figure 9 & 10.

**Figure 9.****Figure 8.**

Mark the mounting locations with a marker or center punch and drill a 11/32" hole for the 3/8" self-tapping bolts. **Important: Make sure that the hole locations do not drill into the hydraulic reservoir or lines.** It is recommended to use a drill or impact when installing the 3/8" self-tapping bolts. **NOTE:** If installing on a RD Series header, the two mounting brackets closest to the middle of the header will require 2 - 3/8" washers used for spacing the mounting bracket up at the back. Refer to BLACK arrow in Figure 9.

**Figure 10.**

Adjust the crop catcher in a position that allows the operator to see the cutting edge. The more upright the crop catcher can be made, the less dust that will collect on the back of the glass. Refer to Figure 10. Once the uprights are bolted in the desired position, push the glass assembly down and leave a small gap between the header and the Crop Catcher, this will make it easier to keep clean. The carriage head bolts on the Upright Support Brackets can now be tightened to 50in-lbs of Torque. **DO NOT OVER TIGHTEN** as damage may occur to the glass.

To Care for your new Crop Catcher, use a plastic cleaner such as the optimal "Dust Away" Plastic Cleaner supplied by Michel's. Do not use Glass Cleaner.

For assistance on your Crop Catcher, please contact Michel's Industries Ltd.

Michel's Industries, Ltd.

P.O. Box 119

St. Gregor, Saskatchewan

S0K 3X0 Canada

Ph#(306)366-2184 or Fax#(306)366-2145