

JOHN DEERE HD SERIES HEADER

CROP CATCHER INSTRUCTION MANUAL



To Care for your new Crop Catcher, use a plastic cleaner such as the optimal “Dust Away” Plastic Cleaner supplied by Michel’s. Do not use Glass Cleaner

For assistance on your Crop Catcher, please contact Michel’s Industries Ltd.

Approximate time to complete installation is 1-1/2” hours for two people

Recommended tools required for installing the Crop Catcher:

- | | | | | |
|---------------|-----------------|-------------|--------------------------|---------------------------|
| -Socket Set | -Wrench Set | -Ratchet | -Extension | -#2 Phillips Screw Driver |
| -Center Punch | -1/4” Drill Bit | -3/8” Drill | -Large Flat Screw Driver | |

Michel's Industries, Ltd.

P.O. Box 119

St. Gregor, Saskatchewan

S0K 3X0 Canada

Ph#(306)366-2184 or Fax#(306)366-2145

Glass Forming Procedure:

Remove the protective covering on the plastic and wash with soapy water. **Do not use Glass Cleaner to clean the plastic, use the optimal "Dust Away" Plastic Cleaner supplied by Michel's.** Glass cleaner will create unwanted static build up and cause dust to stick to the plastic.

The panels that are supplied with your Crop Catcher have grooves cut into them where they are to be formed. These

grooves need to be on the front of the panel when they are formed. See Figure 2. The panels can be formed with your hands. It is important to bend the panels completely until the edges of the grooves touch. Over bending **WILL NOT** cause damage to the panel. Note: Panels may want to straighten out over time and can be re-bent if needed.

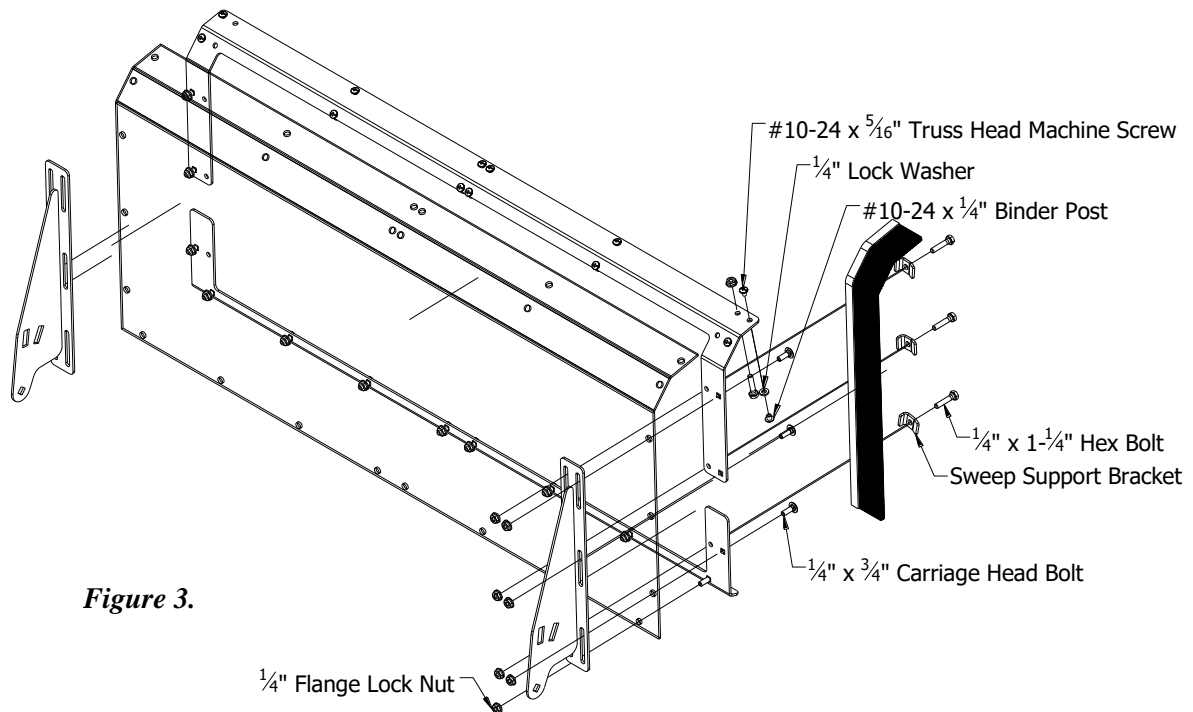
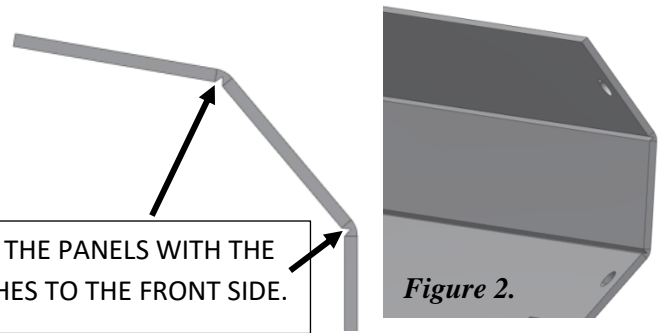

Figure 3.

STEP 1

Assembling the panels for each side. Install the Top Support Bracket on the front side of the clear panel using #10-24 x 5/16" Truss Head Machine Screws, 1/4" Lock Washers, and #10-24 x 1/4" Binder Posts. Use a #2 Phillip Screw Driver and a Large Flat Screw Driver to tighten. Insert the Binder Post from the top side and insert the Barrel Nut and Lock Washer from the bottom. Leave the top inside hole open where the sweep will be mounted.

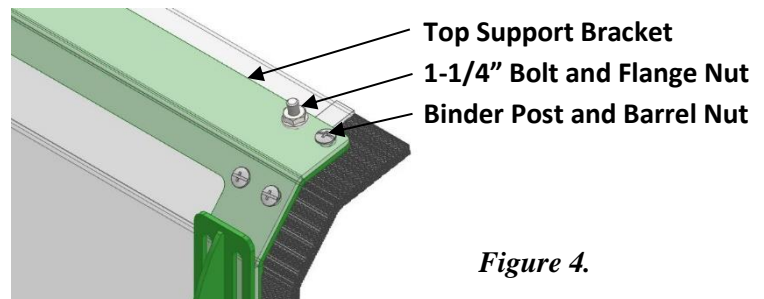

Figure 4.

Note: If the plastic panels do not have all of the holes for the Binder Post and Binder Barrel Nuts, drill a 1/4" hole using the Top Support Inside Brackets as a guide.

STEP 2

Loosely bolt the Upright Support Assembly on the back side of the Clear Panel with 1/4" x 3/4" Carriage Head Bolts and 1/4" Flanged Lock Nuts. Install the Bottom Support Bracket onto the front side of the Clear Panel using 1/4" x 3/4" Carriage Head bolts and 1/4" Lock Nuts. The bent flange on the Bottom Support Bracket is to be mounted forward.

STEP 3

Clamp the sweep onto the front side of the plastic panel using the Sweep Support Brackets, $\frac{1}{4}$ " x $1-\frac{1}{4}$ " bolts and flange nuts. The clear panel will have to be drilled with a $\frac{1}{4}$ " drill bit to mount the sweep. Install the sweep on the opposite side of the second panel to create a left side and right side panel.

Use $\frac{1}{4}$ " x $1-\frac{1}{4}$ " Hex Bolts, Sweep Support Bracket, and $\frac{1}{4}$ " Flanged Lock Nuts to mount the 2" Sweep to the panel. See Figure 3-5. **Note:** Do not tighten hardware until completely assembled.

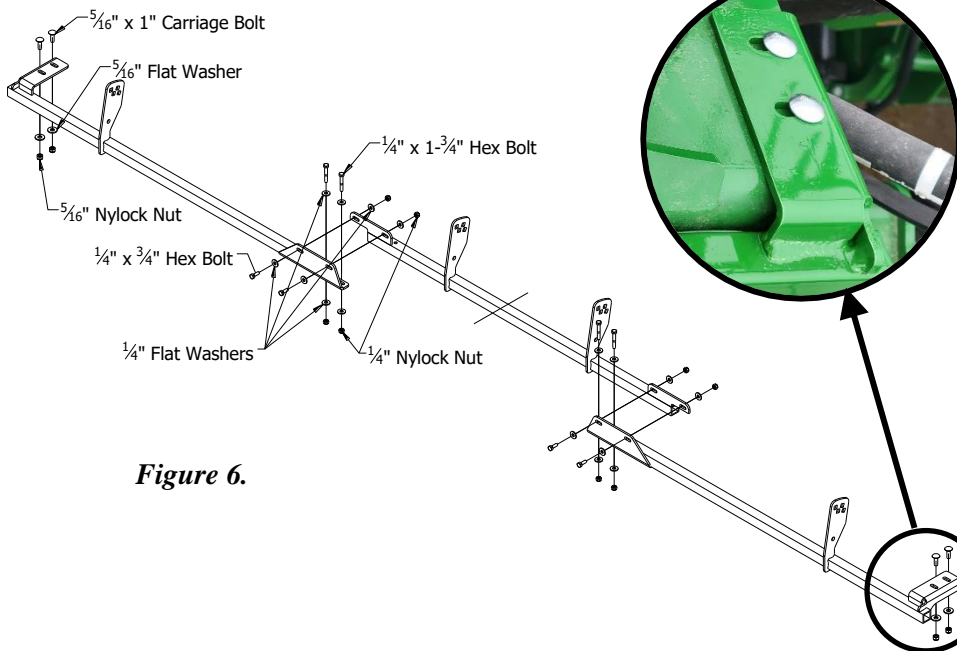
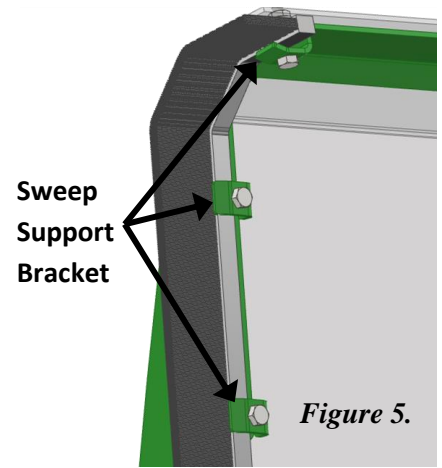
**Figure 6.****Figure 5.****STEP 4**

Install the Mounting Hardware to the John Deere HD Header. Use $\frac{5}{16}$ " x 1" Carriage Bolts, $\frac{5}{16}$ " Flat Washers, and $\frac{5}{16}$ " Nylock Nuts to install the 2 outside Mounting Brackets to the header, using the existing factory holes in the header. Use $\frac{1}{4}$ " x $1-\frac{3}{4}$ " Hex Bolts, $\frac{1}{4}$ " x $\frac{3}{4}$ " Hex Bolts, $\frac{1}{4}$ " Washers, and $\frac{1}{4}$ " Nylock Nuts to secure the Center Mounting Assembly to the Outside Mounting Assemblies.

Note: Leave all Hardware loose until the Panels are mounted. See Figure 6.

STEP 5

Install the Panels onto the Mounting Bracket Assembly using $\frac{3}{8}$ " x $\frac{3}{4}$ " Carriage Head Bolts and $\frac{3}{8}$ " Flanged Nuts. Refer to Figure 7. Once installed tighten all hardware including all the hardware for the Mounting Bracket Hardware.

Adjust the crop catcher in a position that allows the operator to see the cutting edge. The more upright the crop catcher can be adjusted, the less dust that will collect on the back of the panel. Once the uprights are bolted in the desired position, push the panel assembly down and leave a small gap between the header and the Crop Catcher, this will make it easier to keep clean. The carriage head bolts on the Upright Support Brackets can now be tightened to 50in-lbs of Torque. **DO NOT OVER TIGHTEN** as damage may occur to the glass.

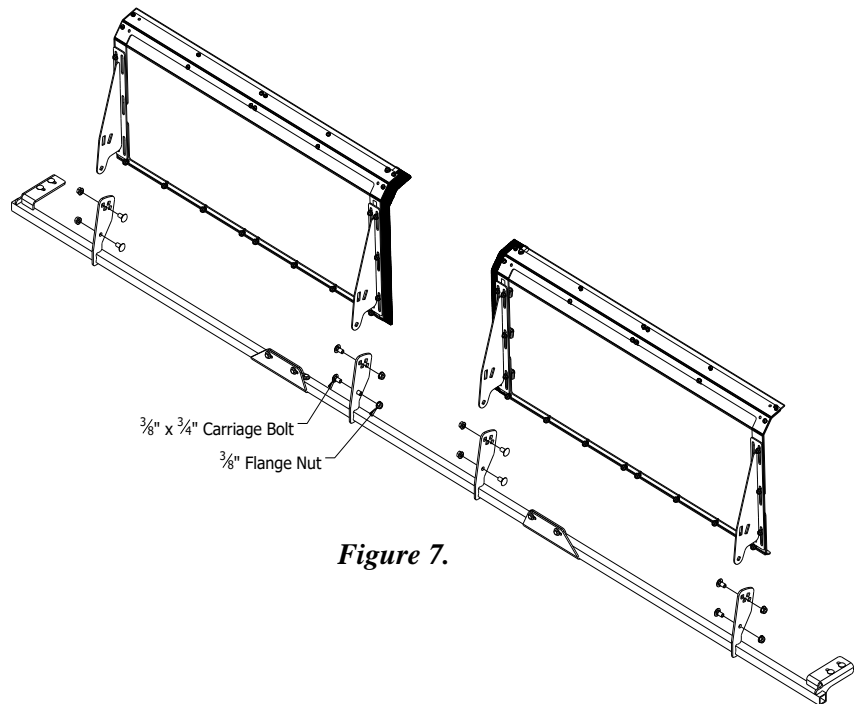
**Figure 7.**

Mitchell's Industries, Ltd.

P.O. Box 119

St. Gregor, Saskatchewan

S0K 3X0 Canada

Ph#(306)366-2184 or Fax#(306)366-2145