

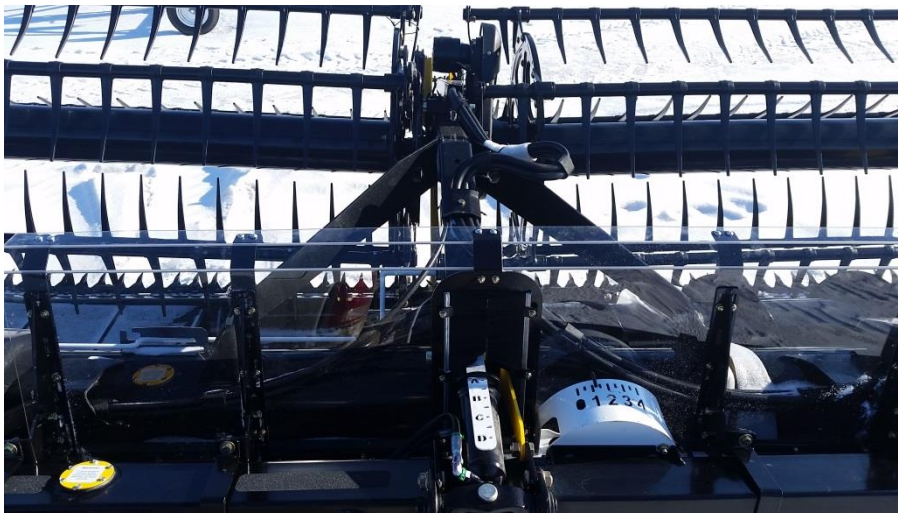

Michel's CROP CATCHER II

MacDon FD 75, FD130, FD135, FD140, & FD145 INSTRUCTION Patent Pending MANUAL



Approximate time to complete installation is 1-1/2" hours for two people

Recommended tools required for installing the Crop Catcher:

- | | | | | | |
|---------------|---------------|------------------|--------------|-------------|------------|
| -9/16" socket | -9/16" wrench | -7/16" socket | -7/16 wrench | -Ratchet | -Extension |
| -Hammer | -Center Punch | -9/32" Drill Bit | -3/8" Driver | -3/8" Drill | |

Michel's Industries, Ltd.

P.O. Box 119

St. Gregor, Saskatchewan

S0K 3X0 Canada

Ph#(306)366-2184 or Fax#(306)366-2145

#	PART NUMBER	DESCRIPTION	QTY
1	0113-000210	MacDon FD75 Glass 2 Bend Right Side	1
2	0113-000211	MacDon FD75 Glass 2 Bend Left Side_MIR	1
3	0011-000607	MacDon FD75 Bottom Right Bracket_MIR (11ga Steel)	1
4	0011-000606	MacDon FD75 Bottom Left Glass Support Bracket (11ga Steel)	1
5	0011-000623	MacDon FD75 Inside Glass Support 2 Bends	4
6	0011-000622	MacDon FD75 2 Bend Center Glass Support Bracket	1
7	0011-000603	MacDon FD75 Rear Attachement Bracket	4
8	0011-000601	MacDon FD75 Mounting Bracket	2
9	0011-000602	MacDon FD75 Mounting Bracket_MIR	2
10	0011-000621	MacDon FD75 2 Bend Upright Straight Support Bracket	4
11	0011-000610	MacDon FD75 3" Sweep Support Bracket (11ga Steel)	6
12	0011-000613	3" Brush Sweep x 13.75" long	2
13	0106-140001	10-24 x 5/16" Truss Head Phillips/Slot Machine Screw Zinc	8
14	0101-001200	1/4" Lock Washer	8
15	0106-140000	10-24 x 1/4" Binder Post Zinc	8
16	0105-009002	1/4" x 3/4" Carriage Head Bolt	34
17	0149-000100	Michel's Dust Away - Panel Cleaner	1
18	0100-001102	3/8" Nylok Hex Nut	12
19	0105-009215	3/8" x 1" Carriage Bolt	8
20	0101-001002	3/8" USS Flat Washer	8
21	0105-000004	1/4" x 1-1/4" Hex Bolt	14
22	0101-001000	1/4" USS Flat Washer	16
23	0100-001401	1/4" Flange Lock Nut	52
24	0105-000203	3/8" x 1-1/4" NC Hex Bolt	4
25	0106-000005	1/4" x 1" Lag Screw	8
26	0105-000002	1/4" x 3/4" Hex Bolt	2

Unpack and check that all of the parts are with your Crop Catcher:

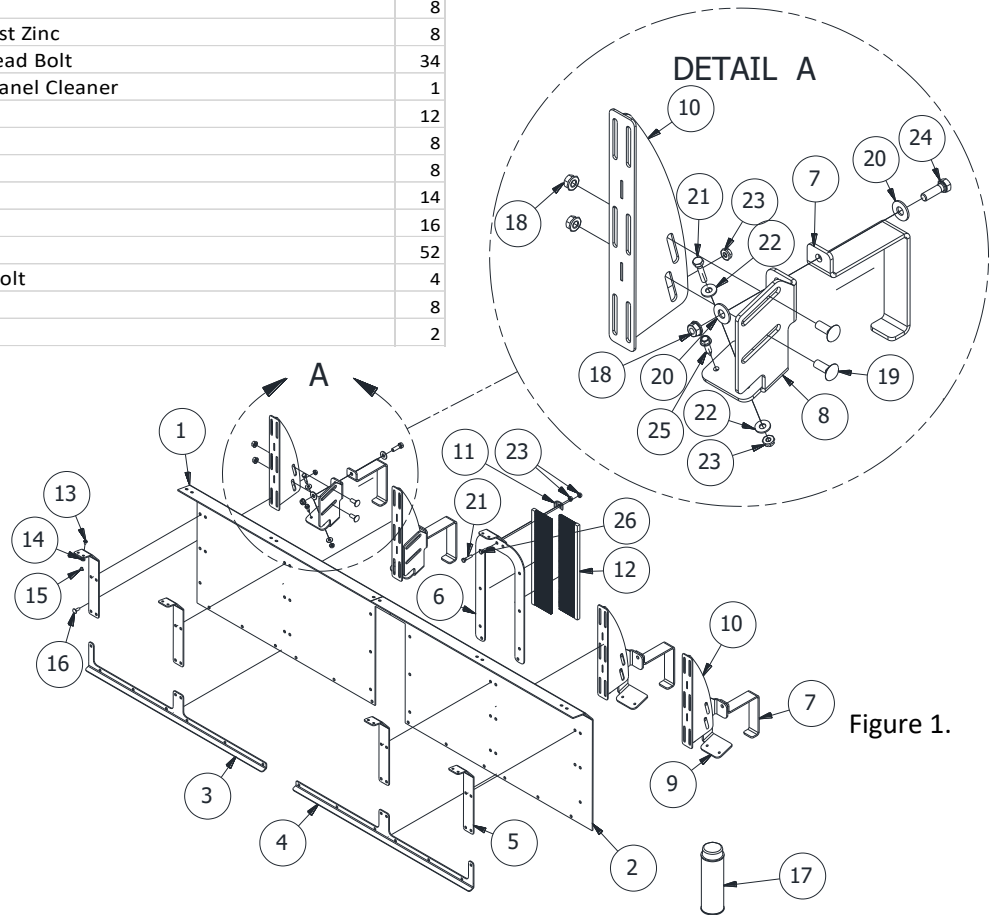
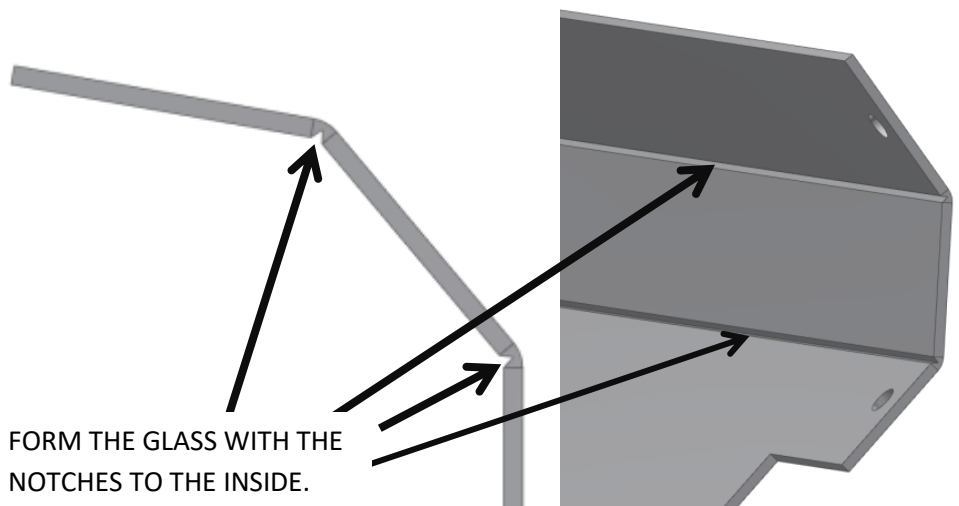

Figure 1.

Glass Forming Procedure:

The glass that is supplied with your Crop Catcher has grooves cut into it where they need to be formed. These grooves need to be on the inside of the glass after they are formed. It is easy to form the glass with your hands. Use #5, MacDon FD75 Inside Glass Support 2 Bends as a guide for how much to form the glass.



STEP 1

Bolt the Upright Support Brackets to the Mounting Brackets using two 3/8" carriage bolts. The Upright Brackets are mounted on the flange side of the Mounting Bracket and the carriage head is also on the bent flange side. Refer to Figure 2 detail view.

Clamp the bracket to a work bench with the bent flange to the inside. Remove the protective covering on the plastic and wash with soapy water. **Do not use Glass Cleaner to clean the plastic, use the optional "Dust Away" Plastic Cleaner supplied by Michel's.** Glass cleaner will create unwanted static build up and cause dust to stick to the plastic.

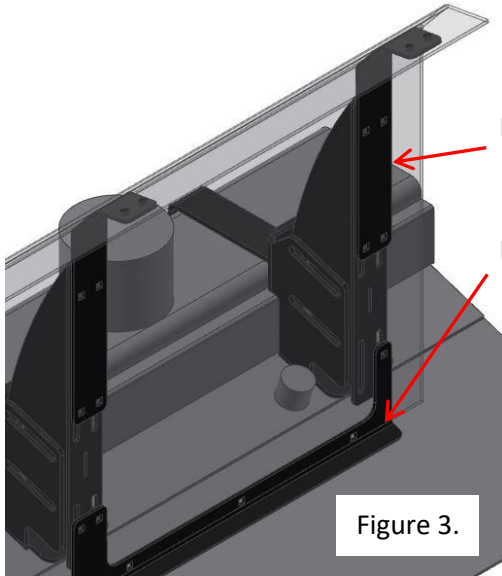
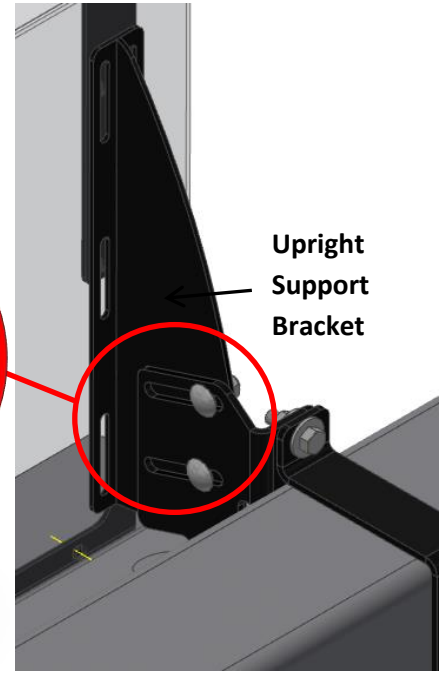

Bent Flange

Inside Plastic Support Bracket

Bottom Plastic Support Bracket

Figure 2.

STEP 2

Install the Outside Support Brackets onto the Plastic using only the top and bottom holes using 1/4" carriage bolts and locking nuts. Do not tighten at this time. Next install the Inside Plastic Support Brackets onto two Upright Support Brackets as see in Figure 3. Note: Nuts are installed on the back side.

Figure 3.

STEP 3

Connect the two sides of the crop catcher using the Center Glass Support Bracket using the top set of bolts. Next place the three inch sweep and secure as shown in Figure 4 using the bent brackets that hold the steel flange of the sweep with the use of 1/4" bolts following the full length of the sweep.

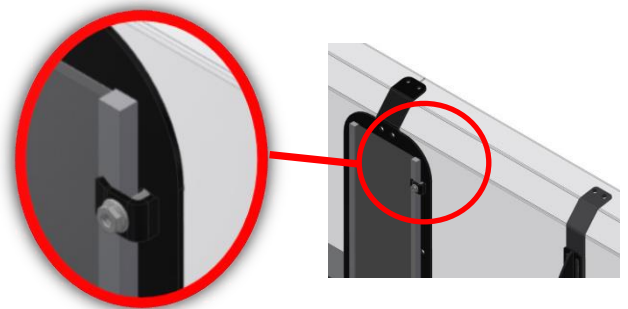

Figure 4.

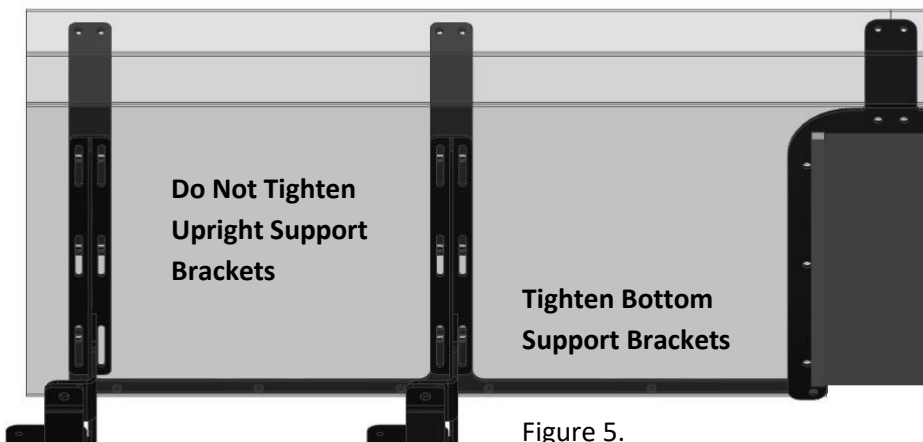

Figure 5.

STEP 4

Once the Crop Catcher is all together the bottom carriage bolts can be tightened. Do not over tighten as it may cause damage to the plastic. It is easier to tighten them if the Crop Catcher is laying on it's face. Refer to Figure 5. Leave the Upright Support Brackets loose so the complete assembly can slide up and down.

STEP 5

Center the Crop Catcher on the combine header and Install the mounting brackets flush with the front of the plastic guard mount plate as shown in Figure 6. Mark the mounting locations with a center punch and drill a 9/32" hole for the 1/4" bolts. Note: If the header is be mounted to the combine it is recommended to use the supplied self-drilling screws for ease of installation. Once the Crop Catcher is mounted in these four spots install the Rear Attachment Brackets around the backside of the oil reservoir.

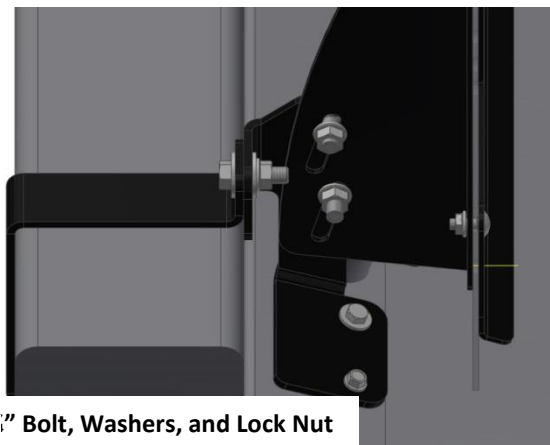

1/4" Bolt, Washers, and Lock Nut

Figure 6.

1/4" x 1/2" Attachment Bracket

STEP 6

To adjust the Crop Catcher refer to Figure 7. The slots in the brackets allow total adjustment to the pitch and height, this will allow for maximum coverage. Once the uprights are bolted in the desired position, push the glass assembly down to have as little space as possible between the header and the Crop Catcher. The carriage head bolts on the Upright Support Brackets can now be tightened to 50in-lbs of Torque; do not exceed 70in-lbs. **DO NOT OVER TIGHTEN** as damage may occur to the glass.



Note:

Any time that the position of the Crop Catcher is adjusted, ensure that it has sufficient clearance. This includes, but is not limited to, the cab, the frame and pivot cylinder on flex draper headers.

To Care for your new Crop Catcher use a plastic cleaner such as the optimal "Dust Away" Plastic Cleaner supplied by Michel's. Do not use Glass Cleaner.

For assistance on your Crop Catcher, please contact Michel's Industries Ltd.

Michel's Industries, Ltd.

P.O. Box 119

St. Gregor, Saskatchewan

S0K 3X0 Canada

Ph#(306)366-2184 or Fax#(306)366-2145